

CR1025



CR1025

Nominal Voltage (V)	Nominal Capacity (mAh)	Standard Discharge Current (mA)	Weight (g)
3	30	0.1	0.7

Dimensions

Unit : mm
Tolerance : +/- 0.3mm
Not in Scale

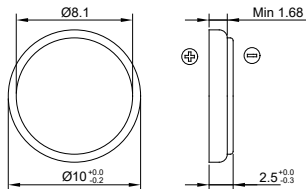

Standard Characteristics

Discharge Characteristics

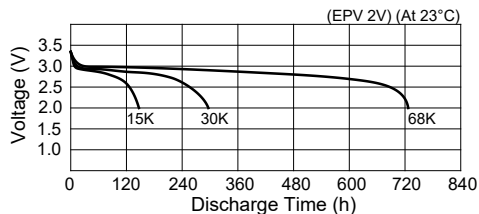

Pulse Discharge Characteristics

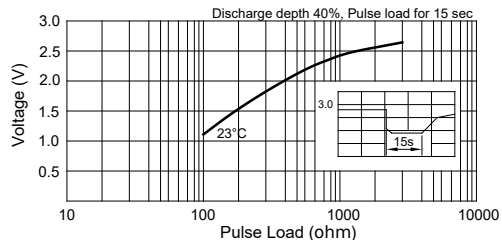

Discharge Characteristics at Different Temperature

