

CR1620



CR1620

Nominal Voltage (V)	Nominal Capacity (mAh)	Standard Discharge Current (mA)	Weight (g)
3	70	0.2	0.6

Dimensions

Unit : mm
Tolerance : +/- 0.3mm
Not in Scale

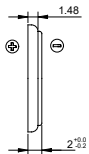
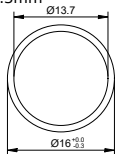

Standard Characteristics

Discharge Characteristics

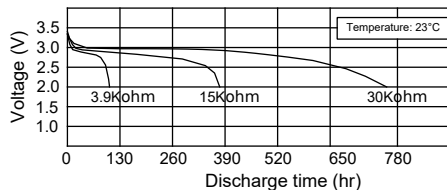

Load-capacity

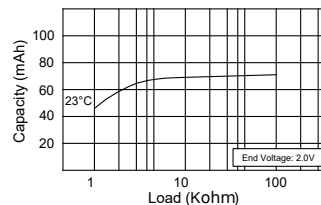

Pulse Discharge Characteristics

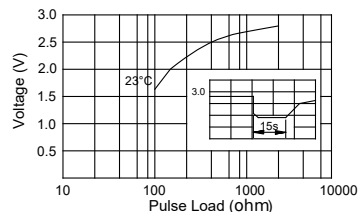

Temperature Characteristics

